



# HEATHCOTE *and* STAR

*Host your event with us*









# YOUR LOCAL

---

Originally opened in 1905 as a hotel, the Heathcote & Star is now a beautiful community-led pub. Revamped, restored and reopened in 2017, our contemporary venue is located at the heart of Leytonstone.

It boasts two function rooms, a games room and a delightful beer garden. We have been championing London's best street food traders in our kitchen for years.

Oh and did we mention we're dog friendly?





# WHICH ROOM IS THE ONE FOR YOU?

---

We have a selection of exclusive areas to book for between 10 and 200 people.

Have a look at our beautiful and varied spaces for hire.

*Pink Party Room*

*Games Room*

*Grove Green Room*

*Garden*











# THE PINK PARTY ROOM

---

Our stunning pink function room has space for up to 70 guests standing or 30 seated. It features a dedicated sound system, tv screen, private toilets and its own bar.

Its bright decor and large windows create a luminous atmosphere, ideal for any event. It can be arranged in a variety of bespoke arrangements to suit any celebration.

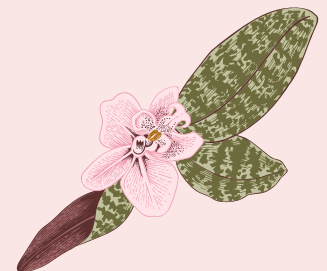

# PINK ROOM







# GAMES ROOM

Our star covered Games Room can hold up to 150 people and features large screen televisions, pool tables and table tennis tables. A modern room, created for people to have a good time watching sport or playing games.





# GAMES ROOM

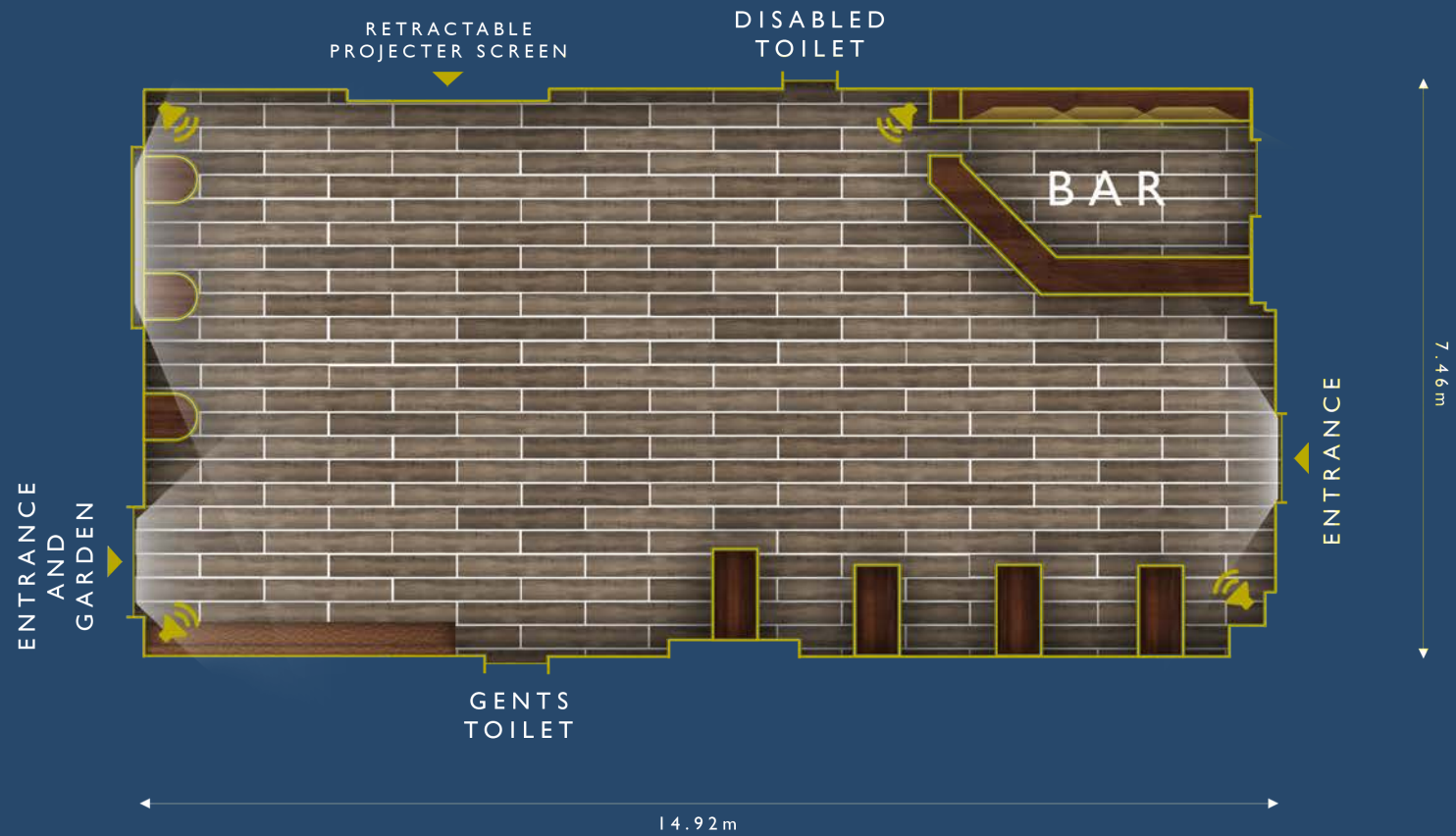





# GROVE GREEN ROOM

---

Our charming room upstairs boasts beautiful leaded Edwardian windows and extremely high ceilings. The room is suitable for up to 200 people standing or 120 seated.

It has its own private bar, private toilets, exclusive sound system and large screen projector. It has ample space for any meal, wedding or party.





# GROVE GREEN ROOM

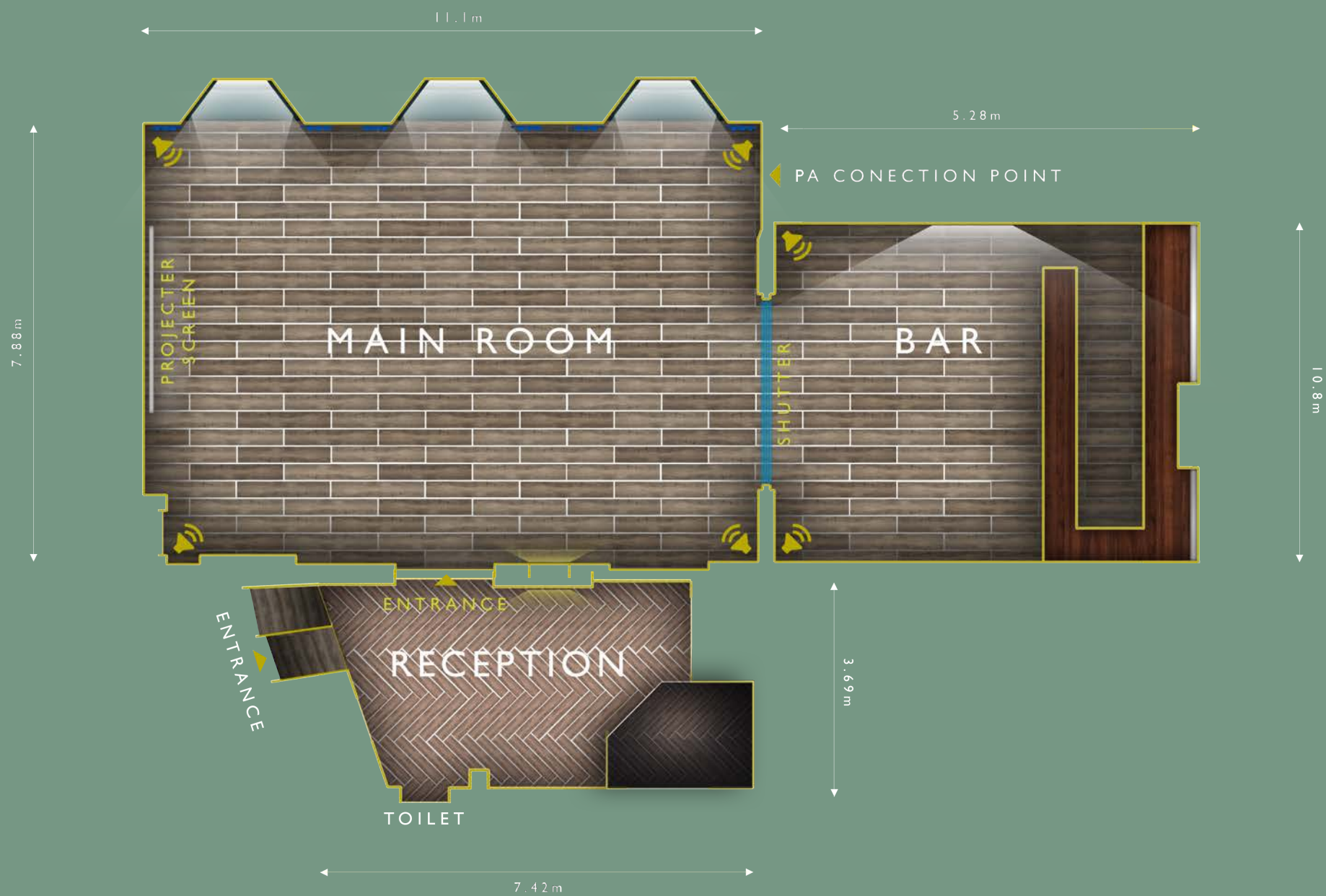



# GARDEN

---

Our garden is the biggest and best in Leyton, where we can fit over 130 people. It has its own private slushie bar which can be booked in to make your experience that bit better.

During autumn and winter, it is covered by an all weather stretch tent to keep you dry.

You can book a table, a space or the whole garden for any event or party.









# DRINKS

*This is a small sample of the amazing variety of drinks we have available on site.*

## DRAUGHT BEER/CIDER

Becks 4%	4.90	Urban Orchard Cider 4.5%	5.00
Camden Hells 4.3%	5.40	Guinness 4.3%	5.60
Camden Pale 4%	5.40	Lucky Saint 0.0%	5.10

*Guests beers on rotation from Two Tribes, Signature Brew, Purity and Orbit.*

## SPRITZ & COCKTAILS

<b>APEROL SPRITZ</b>	9.50	<b>NEGRONI</b>	9.00
Aperol, prosecco, over ice topped with soda and slice of orange		Beefeater, Campari, sweet vermouth, stirred over ice with a slice of orange.	
<b>CAMPARI SPRITZ</b>	9.50	<b>MARGARITA</b>	9.00
Campari, prosecco, served over ice and topped with soda and a slice of orange.		Jose Cuervo tequila, fresh Lime, countreinu, shake with ice and strained into a martini glass.	
<b>CRODINO SPRITZ</b>	4.50	<b>GIN COLLINS</b>	9.00
Crodino A non alcoholic Aperol Spritz. You will never know the difference. Served over ice & garnished with an orange wedge.		Beefeater Gin, lemon juice, Sugar shaken with ice and topped up with soda and a wedge of lemon.	
<b>ELDERFLOWER SPRITZ</b>	6.50	<b>ESPRESSO MARTINI</b>	9.00
White wine, elderflower cordial, sparkling water and fresh grapefruit wedge.		Vanilla vodka, Kahlua, coffee and sugar shaken over ice and strained into a martini glass.	

## HOUSE SPIRITS & MIXER

	Single	Double
Eristoff Vodka, Beefeater Gin, Havana 3yr	5.00	8.60
Rum, Four Roses Bourbon		
Ceder 0% Non-alcoholic Gin	4.60	7.90

*Plus an great selection of gins, rums, whiskies and tequila for every taste.*

## WINES

*Pick from our great selection of wines from across the world.*

### SPARKLING

	125ml		Bottle
Spumante - Gran Cuvee, Italy (vg)	6.00		29.00
Prosecco - Extra Dry, Ca' del Console, Italy (v)	6.50		35.00
Scavi & Ray 0% sparkling wine			29.00
Veuve Clicquot Champagne			79.00

### WHITE

	125ml	175ml	250ml	Bottle
Bianco - Pieno Sud, Terre Siciliane, Italy (v)	4.40	5.10	6.70	19.70
Pinot Grigio - Nina, Italy (v)	5.00	6.10	8.30	24.20
Sauvignon Blanc - Feather Drop, New Zealand	5.70	6.30	9.70	28.50

### ORANGE

	125ml	175ml	250ml	Bottle
Orange Zero G	6.50	9.30	12.40	37.00
Soto Manrique La Vina de Ayer Albillo Real	6.00	8.20	10.90	32.00

### ROSÉ

	125ml	175ml	250ml	Bottle
Pinot Grigio Rosé - Nina, Italy (v)	4.60	5.50	7.00	20.90
Provence Rosé - Saint-Roch Les Vignes, France	5.90	7.50	9.90	29.00

### RED

	125ml	175ml	250ml	Bottle
Rosso - Pieno Sud, Terre Siciliane, Italy (v)	4.40	5.10	6.70	19.70
Primitivo, Italy	4.80	5.50	7.60	22.50
Malbec - Norton Porteno, Argentina (v)	5.50	7.00	9.20	27.50





## MAIN MENU



HEATHCOTE  
and STAR

### SMALLS, SIDES & SALADS

Thai Prawn Crackers **£3.5**  
w/ sweet chilli dip (GF)

Som Tam \* **£9**  
Classic fiery green papaya salad (GF)

Yard Long Beans **£6**  
Stir fried in tamarind, garlic and chilli (Vg)

Spicy Pumpkin Fritters **£6.5**  
w/ Bird's eye chilli dip (Vg, GF)

Miang Bites **£9**  
One bite tamarind prawns  
served on (edible) betel leaves (GF)

Larb  
Spicy herb salad with lime leaf and  
roasted rice powder (GF)

- Roasted cauliflower (Vg) **£8**  
- Chicken **£8**

Pork Bites **£9**  
Pork belly with chilli jam and Thai basil

### GRILL

Gai Yang **£10**  
Chilli & lemongrass BBQ chicken (GF)

Moo Ping **£8**  
BBQ pork skewers, served w/ nam  
jim jaew

V - Vegetarian  
Vg - Vegan, or option available  
GF - Gluten free  
\* - Vegan option available

Please inform us of any  
dietary preference, requirements  
or allergies.

### LARGE PLATES

KraPow Moo **£13**  
The signature dish! Chilli & basil pork  
mince stir-fry served on rice w/ fried egg

PowPow Wings **£10**  
Crispy chicken wings. Choice of glaze:  
• Fish sauce glaze (GF)  
• Ginger & Sriracha  
• Chilli Jam & Thai basil

Gai Tod Burger **£12**  
Thai fried chicken burger w/ Sriracha  
mayo & house slaw

Vegan Gai Tod Burger (Vg) **£12**  
Vegan chicken burger w/ Sriracha mayo &  
house slaw

Pad Kee Mao (Thai Drunken Noodles)  
Classic spicy rice noodle stir-fry  
- Veg (Vg) **£11**  
- Chicken **£11**

Moo Krob **£11.5**  
Deep fried pork belly in a chilli jam and  
Thai basil stir fry. Served w/ jasmine rice

### CURRIES

Red Classic thick & spicy curry (GF)  
- Pumpkin (Vg) **£10.5**  
- Chicken **£11**

Massaman Rich, thick & mild curry (GF)  
- Beef **£13.5**

### RICE

Jasmine Rice **£2.5**  
Single serving (Vg, GF)

Sticky Rice **£3**  
Single serving (Vg, GF)

Thai Fries \* **£4.5**  
Sriracha rub, sriracha mayo, chillies, and  
coriander  
Plain Fries **£3.5**

## FOOD

We're currently joined in the kitchen by  
Thai food maestros Krapow!

They provide delicious menus that are  
lovingly prepared on site by a passionate  
Head Chef, dedicated kitchen team and  
local producers who supply fresh, seasonal  
ingredients.

### Bespoke Set Menus

### Buffet Menus

### Drinks Packages





# WEDDINGS

---

Whether you're looking for somewhere to host an intimate wedding breakfast or just a good old-fashioned knees up, we'd love to offer you the perfect backdrop to your perfect day.

Our team are here to support you with every choice before the big day. We take care of logistics, from setting up the room until after the guests go home, to ensure you can relax and enjoy your special day.

Krapow!, our current kitchen partners, have a range of packages available from buffet menu & set menus. Thinking of having a Prosecco reception or a drink on arrival? Then pick from our selection of drinks packages. Let us prepare bespoke options for you, and we happily cater for any dietary requirements.





# BUSINESS EVENTS

---

From breakfast meetings to all-day training sessions, our Grove Green Room or Pink Party Room are the perfect spaces to get the team out of the office and into a beautiful setting.

The rooms offer excellent facilities with complimentary Wi-Fi and television/projector screen and speaker system for all your presentation needs.



# WAKES AND MEMORIALS

---

We can offer a private, unintrusive and respectful service for funeral receptions, where family and friends are able to come together to share memories and celebrate the life of your loved one.





# WHAT DO YOU NEED TO KNOW?

---

## CAN WE BRING OUR OWN CATERING?

*As we have on-site catering, we do not allow any food or drinks to be brought into the venue (apart from a celebration cake). We have a wonderful buffet menu to offer or if you were interested in a sit down option, we can discuss a bespoke menu.*

## WHAT'S YOUR NEAREST TRAIN STATION?

## DO YOU HAVE NEARBY PARKING?

*We are a 7 minute walk from Leytonstone station, which is on the Central Line or a 10 minute walk from Leytonstone High Road overground station. We don't have a car park but there is residential parking on Pretoria Road and Richmond Road. The restrictions are Monday-Friday 8am-6:30pm.*

## WHAT ARE YOUR OPENING HOURS?

## WHAT TIME IS LAST ORDERS?

Monday - Tuesday 4pm - 11pm

*Kitchen Hours - 4pm - 9pm*

Wednesday-Thursday 12pm-11pm

*Kitchen hours 12pm-9pm*

Friday-Saturday 12pm-1am

*Kitchen Hours 12pm-10pm*

Sunday 12pm-11pm

*Kitchen hours 12pm-8pm*

*Last orders is the same as closing time,  
with 20 minutes drinking up time afterwards.*





## WE WOULD LOVE TO PUT DECORATIONS UP, ARE WE ALLOWED?

*We think our rooms look great on their own but subject to prior agreement, you can of course decorate your event area. Please refrain from using any sellotape or pins on the walls as this can damage the wallpaper.*

*Confetti, confetti balloons, glitter and streamers are not permitted as they stain the furniture and upholstery. A cleaning fee will be added to your final bill if you are found to have used any of the above.*

## CAN I HAVE A LIVE BAND/DJ AT MY FUNCTION?

*We can have acoustic live bands in both of our function rooms up until 10pm. We also welcome DJs and can play until closing time.*

## WE'VE ORGANISED A DJ, THEY WANT TO KNOW WHAT EQUIPMENT YOU HAVE?

*We have a Pioneer CDJ 900s and an Allen + Heath mixer available in our rooms.*

## WE WANT TO PLAY OUR OWN MUSIC, CAN I PLUG MY PHONE IN?

*Absolutely! We have a headphone jack aux lead so depending on what device you have, you may need to bring an adapter with you.*

## WHAT'S YOUR POLICY ON CHILDREN ATTENDING THE VENUE?

*Due to licensing restrictions, under 18s are not allowed on the premises after 8pm.*

## DO YOU HAVE DISABLED ACCESS?

*We do! Our Pink function room is on the ground floor and we have a disabled toilet in the main pub. Our Grove Green room upstairs is only accessible via flight of stairs and doesn't have a disabled toilet.*

## WHAT ARE YOUR DEPOSIT, CANCELLATION AND PRE-ORDER POLICIES?

*We require payment of the hire fee to secure the booking. Our cancellation policy is 30 days notice for a full refund. We ask for one weeks notice for any pre-order.*





# GIVE US A SHOUT

Heathcote & Star,  
344 Grove Green Road,  
London, E11 4EA

020 7458 4483

[bookings@heathcoteandstar.co.uk](mailto:bookings@heathcoteandstar.co.uk)

[@heathcotestar](https://www.instagram.com/heathcotestar)

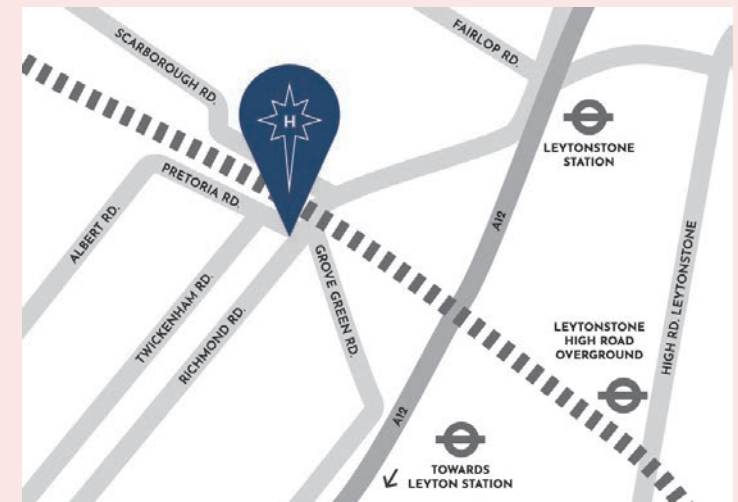

*Find us on Google Maps*